

Plan View Elevation

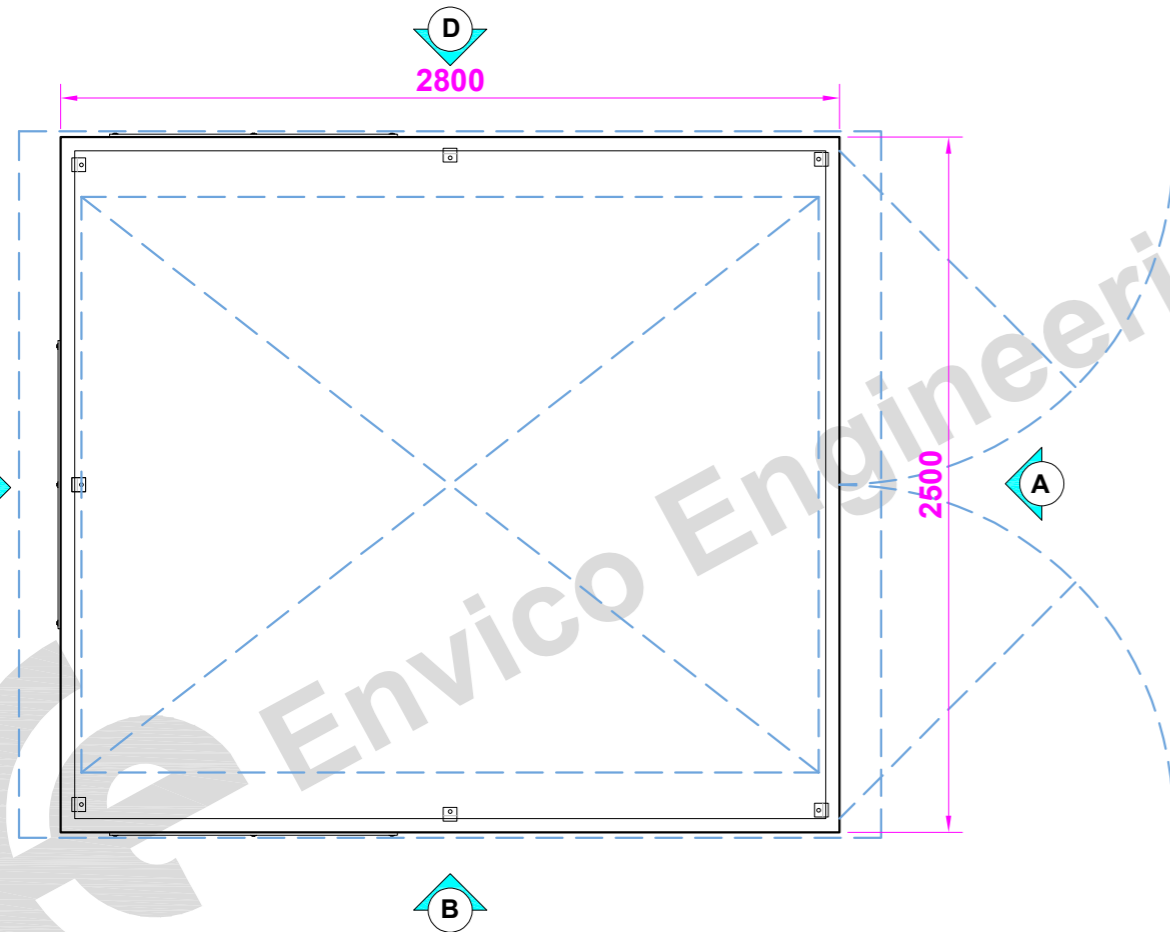

Elevation (A) (front)

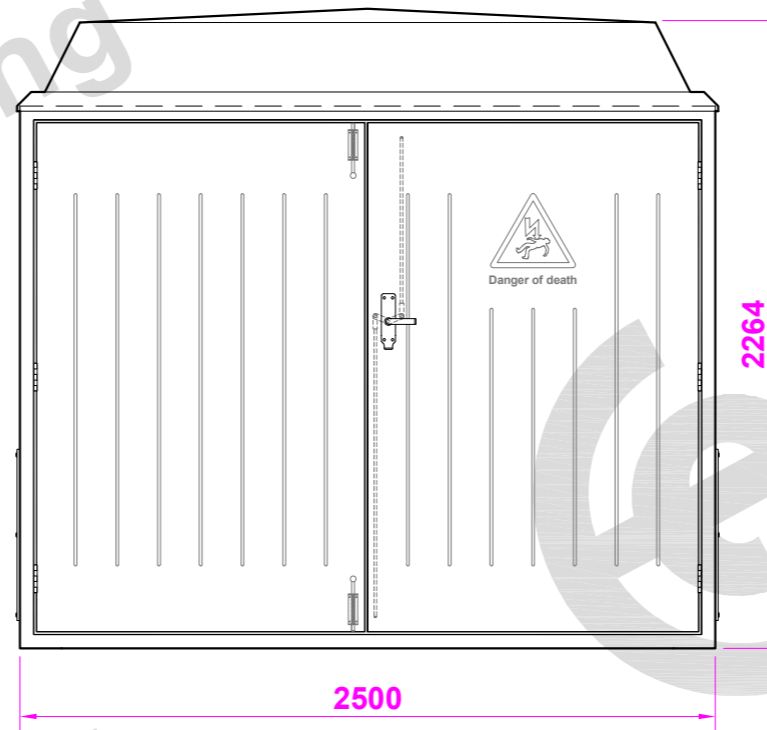

TYPICAL STEPPED BASE DETAIL (RECOMMENDED)

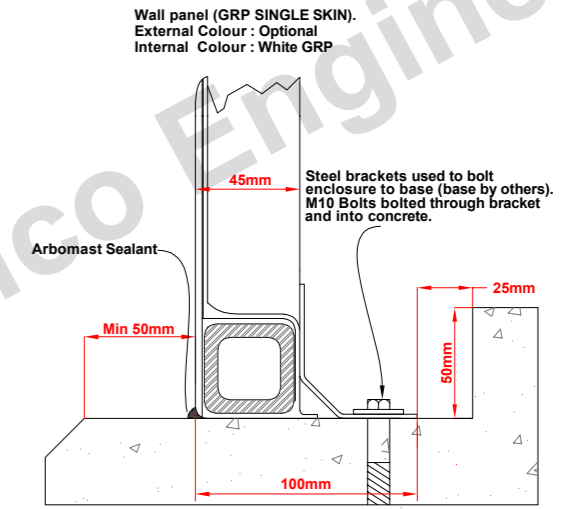

Elevation (B) (l/h side)

ROOF OVERHUNG AT FRONT AND REAR TO PROVIDE HIGH LEVEL VENTILATION

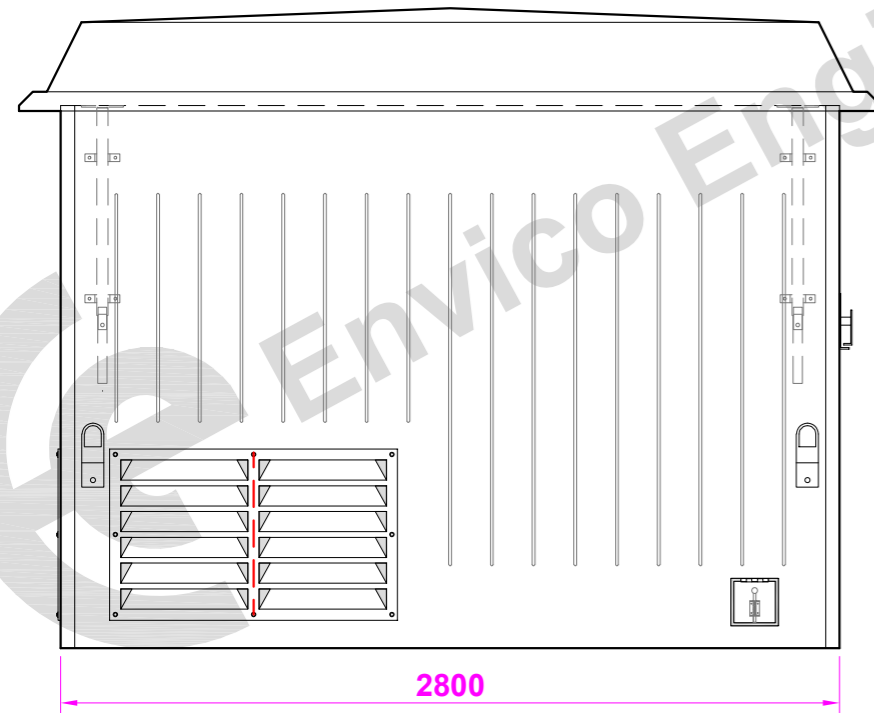

Elevation (C) (rear)

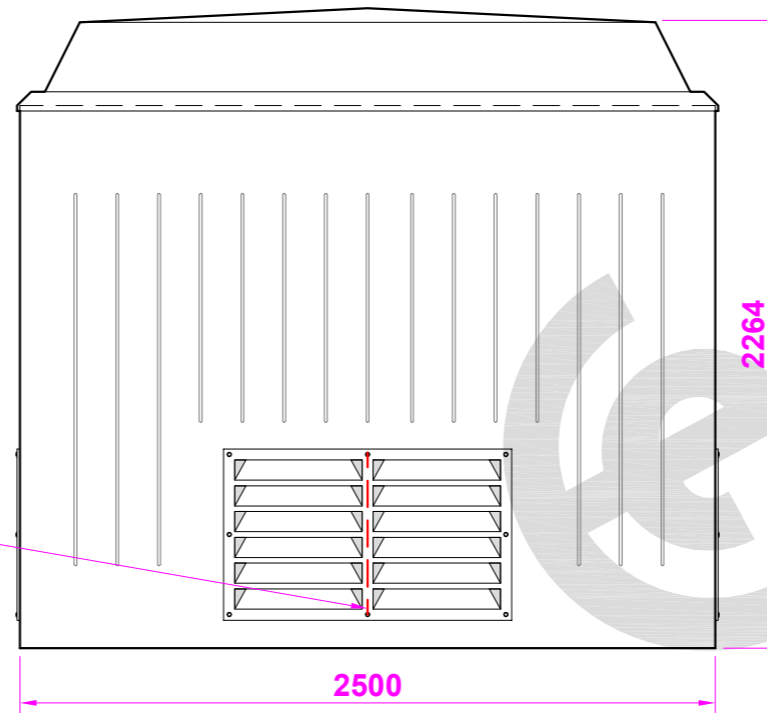

Elevation (D) (r/h side)

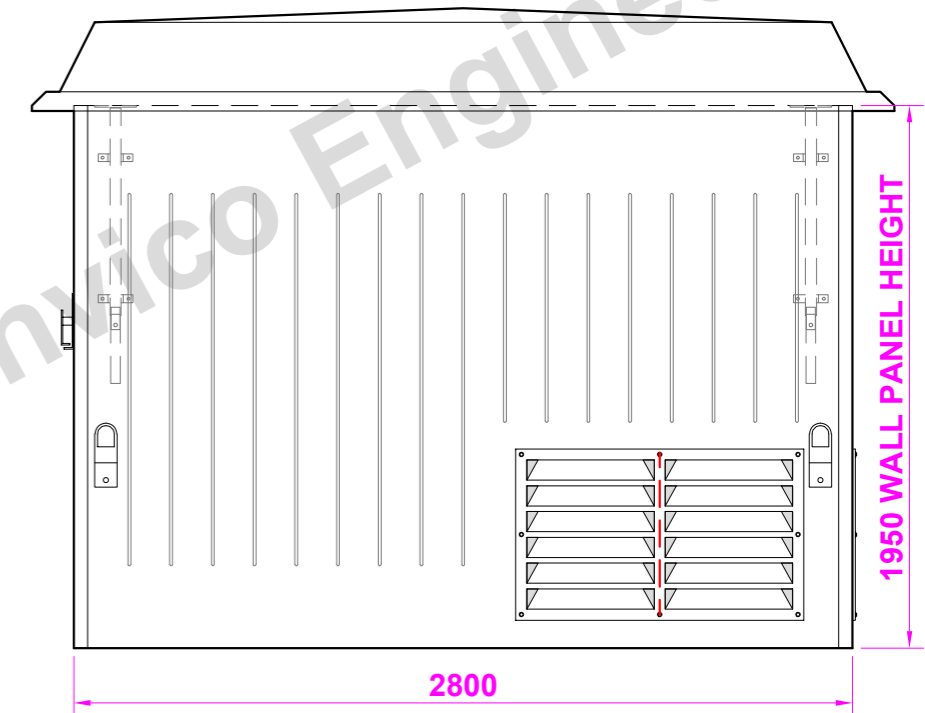

CLS TIMBER SUPPORT

PARTS LIST

ITEM	QTY.	COMMENTS	ITEM	QTY.	COMMENTS
GRP DOUBLE DOOR	1	2400mm X 1850mm	ALU LOUVRE VENTS 1035mm X 616mm	3	ELEVATIONS B, C & D
STAINLESS STEEL DOOR HINGES	4	ELEVATION A	EXPLOSION RELIEF BRACKETS	4	ELEVATIONS B & D
ST - STEEL ESPAGNOLETTE LATCH	1	ELEVATION A	LIFTING EYES	4	ELEVATIONS B & D
ST-STEEL SPRING TOWER BOLTS	2	ELEVATION A	ST - STEEL FIXING FEET	7	DRILLED FOR M10 X 100 BOLTS
ST- STEEL DOOR STAYS	2	ELEVATION A	DANGER OF DEATH DOOR MOULD	1	ELEVATION A (ON DOORS)
			GENERATOR CABLE HATCH 170mm X 170mm	1	ELEVATION B

CONSTRUCTION DETAILS

INTERNAL WIDTH : 2390mm
INTERNAL DEPTH : 2690mm
INTERNAL HEIGHT : 2250mm

EXTERNAL WIDTH : 2500mm
EXTERNAL DEPTH : 2800mm
EXTERNAL HEIGHT : 2264mm

G.R.P CONSTRUCTION

LAYER 1. GEL COAT, COLOURED.
LAYER 2. 450GRM/M.SQ GLASS & RESIN
LAYER 3. 450GRM/M.SQ GLASS & RESIN
LAYER 4. 450GRM/M.SQ GLASS & RESIN

ALL RESIN TO CLASS II FIRE RETARDANT GRADE.
ALL REINFORCING BETWEEN LAYERS 3 & 4

G.R.P HOUSING MODEL TR5
APPROX WEIGHT: 430kg

Envico Engineering

THE DRAWING AND DESIGN IS THE PROPERTY OF ENVICO ENGINEERING LTD. AND WITHOUT THE WRITTEN CONSENT OF ENVICO ENGINEERING LTD. MAY NOT BE COPIED IN WHOLE OR IN PART OR COMMUNICATED TO A THIRD PARTY OR USED FOR ANY PURPOSE.